

# FAR TOOLS®



Ø 125 mm  
Professional Machine

Contenu du carton  
Contents of box

A



**Pour meuleuse  
d'angle Ø 125 mm  
uniquement !  
For Ø 125 mm  
angle grinder only!**

**Vitesse maxi :  
6000 tr/min  
Max speed : 6000 rpm**



© FAR GROUP EUROPE

115925-Manual-C-20221116

**fartools.com**

Assemblage de la machine  
Assembling the machine

# B



**Pour meuleuse  
d'angle  $\varnothing$  125 mm  
uniquement !  
For  $\varnothing$  125 mm  
angle grinder only!**

**Vitesse maxi :  
6000 tr/min  
Max speed : 6000 rpm**

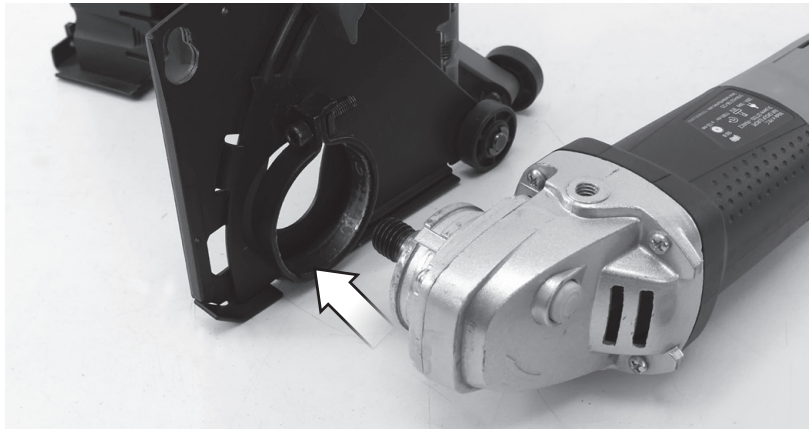

**Si votre meuleuse ne s'adapte pas, utilisez les adaptateurs fournis**  
Wenn Ihre Mühle nicht passt, verwenden Sie die mitgelieferten Adapter  
Als je grinder niet past, gebruik dan de meegeleverde Adapter  
Si su amoladora no encaja, use los adaptadores provistos  
Se o seu moedor não couber, use os adaptadores fornecidos  
Se il tuo macinacaffè non si adatta, usa gli adattatori forniti  
If your grinder does not fit, use the adapters provided

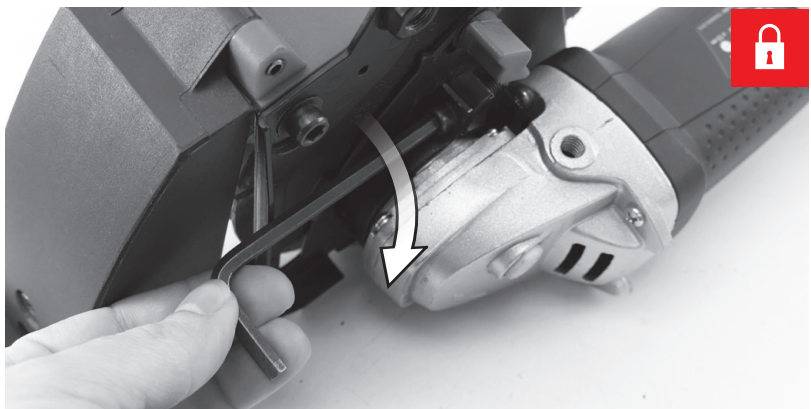
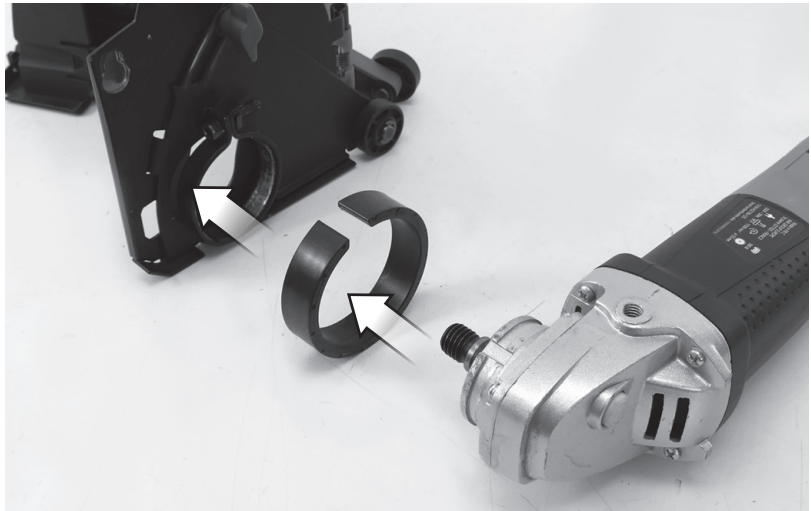

Assemblage de la machine  
Assembling the machine

# B

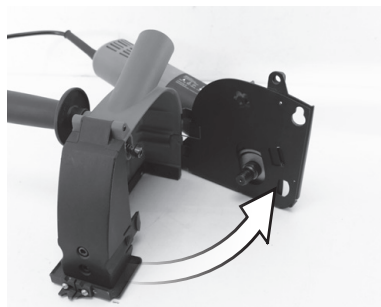
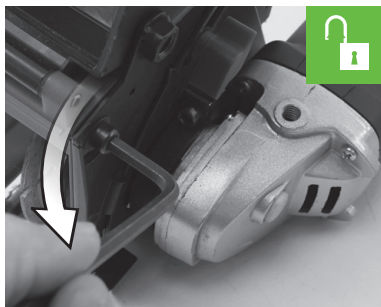

14

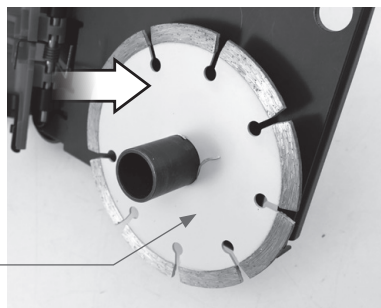
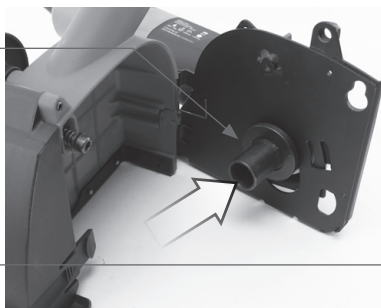
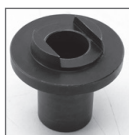

01



09

10

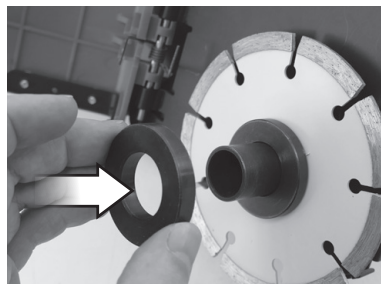
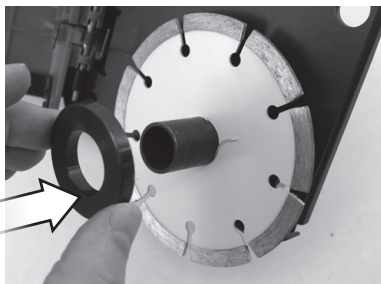

11

12



02

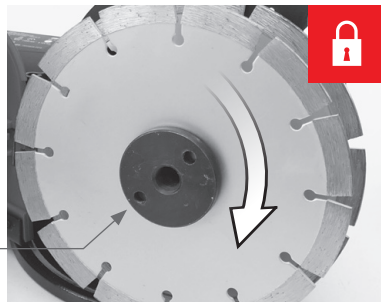
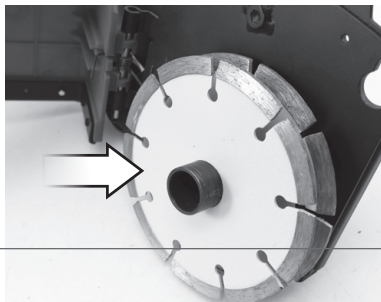

Assemblage de la machine  
Assembling the machine

**B**

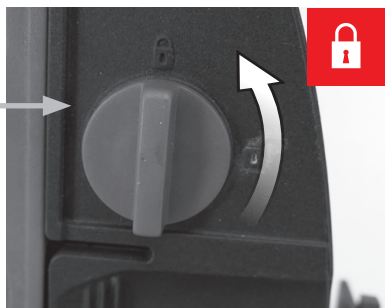
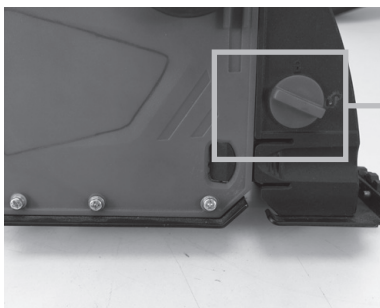
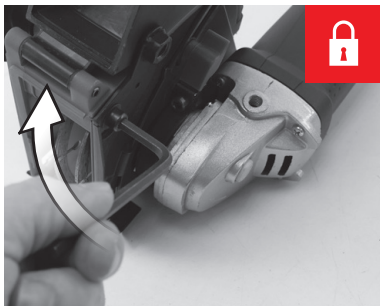

Réglage de la machine  
Settings of the machine

**C**

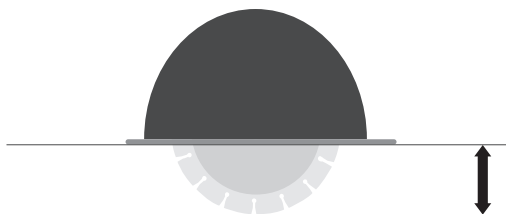
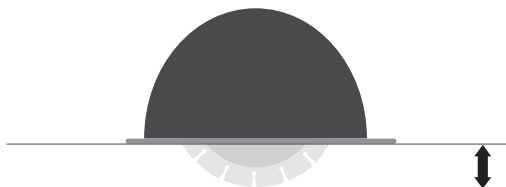
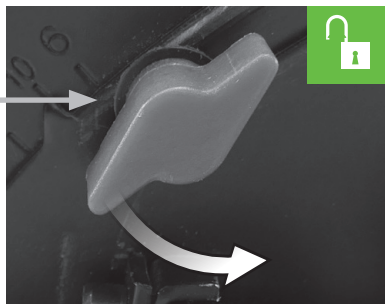
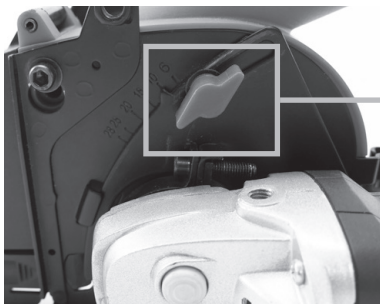





## FAR GROUP EUROPE

Une société du groupe **SIGMA**

192, Avenue Yves Farge  
37700 St. Pierre-des-Corps  
FRANCE

**[fartools.com](http://fartools.com)**

